

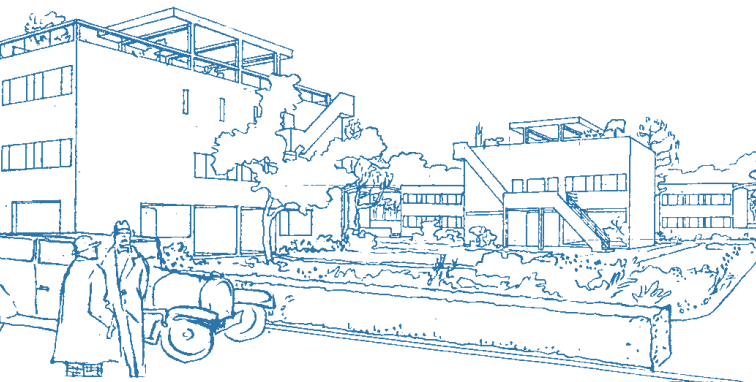

CITÉ FRUGÈS LE CORBUSIER

LES QUARTIERS MODERNES FRUGÈS

More than a laboratory, an emotion to live in



Cité Frugès, part of :



unesco

The architectural work
of Le Corbusier
An outstanding
contribution to
the Modern Movement
World Heritage since 2016

Architectural Promenades
DESTINATIONS LE CORBUSIER
Promenades architecturales

Cultural route
of the Council of Europe
Itinéraire culturel
du Conseil de l'Europe



citefrugeslecorbusier.pessac.fr

CITÉ FRUGÈS

LE CORBUSIER STREET

33600 PESSAC

FROM WEDNESDAY TO SUNDAY
closed on december 25th, january 1st, and may 1st

GUIDED TOURS ENIGM'GAMES FREE

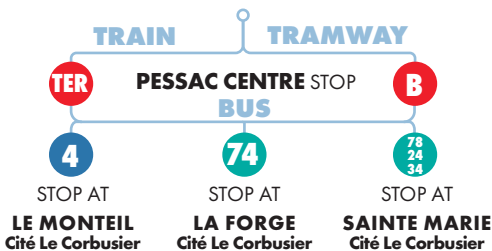
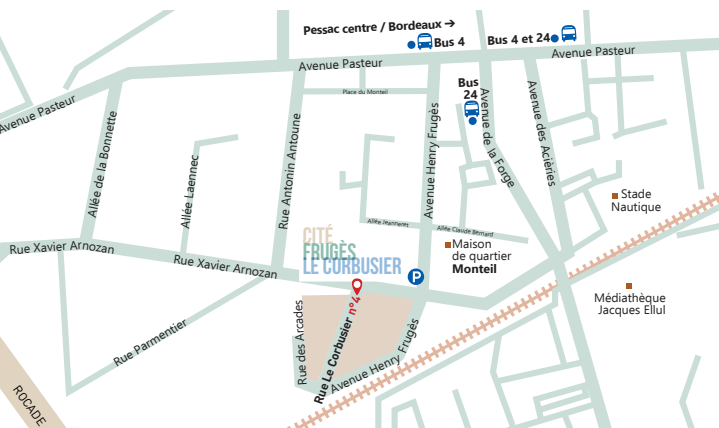

FOR PERSONAL VEHICLES

PARKING LOT IN FRONT OF
15TH HENRY FRUGÈS STREET



INFORMATIONS AND BOOKINGS

ONLINE citefrugeslecorbusier.pessac.fr

DURING OPENING DAYS :

05 56 36 56 46 - lecorbusier.fruges@mairie-pessac.fr



Discover the podcast series

« Une cité laboratoire par Frugès et Le Corbusier »